

FOR CONTINUATION REFER DWG. CT-1172-229

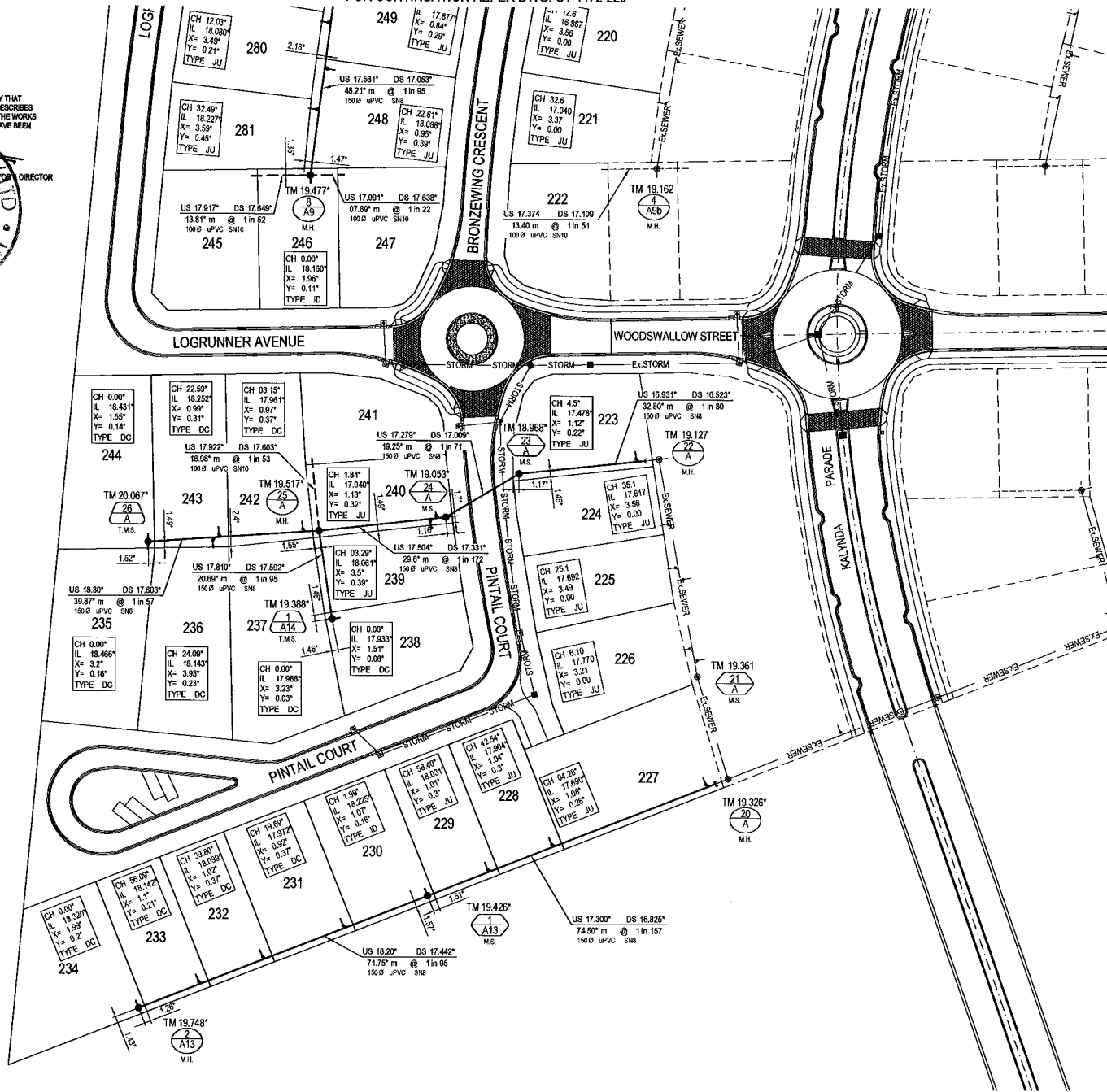

BRAZIER MOTTI PTY LTD. ACN 066 411 041
 565 FLINDERS ST. TOWNSVILLE, HEREBY CERTIFY THAT
 THIS DRAWING ACCURATELY AND CORRECTLY DESCRIBES
 AND RECORDS THE NATURE AND LOCATION OF THE WORKS
 DENOTED BY ASTERISKS (*) HEREON, AS THEY HAVE BEEN
 CONSTRUCTED TO DATE.

DATE: 16.11.06



SEWERAGE LEGEND

EXISTING SEWERAGE:

FUTURE SEWERAGE:

SEWERAGE:

LIMIT OF WORKS - STAGE 3:

SEWER MANHOLE (M.H.)
 TOP OF MANHOLE R.L.
 MANHOLE NUMBER
 LINE NUMBER

HOUSE CONNECTION TYPES

		TYPE A DIRECT CONN.
		TYPE B JUMP UP
		TYPE C DIRECT CONN. M.H.
		TYPE D INTERNAL DROP

- SEWERAGE NOTES**
- ALL LINES LESS THAN 5.7m DEEP ARE 150MM DIAMETER PVCU DWV S/NB IN ACCORDANCE WITH STANDARD AS/NZS 1290:1999. UNLESS SHOWN OTHERWISE.
 - ALL 100mm DIAMETER SEWER LINES LESS THAN 5.7m DEEP ARE PVCU DWV S/N10 IN ACCORDANCE WITH STANDARD AS/NZS 1290:1999. UNLESS SHOWN OTHERWISE.
 - CONTRACTOR VERIFIED FINISHED SURFACE LEVELS ON SITE BEFORE CONSTRUCTION OF SEWERS AND PROPERTY CONNECTION BRANCHES.
 - ALL WORK WERE CONSTRUCTED IN ACCORDANCE WITH CURRENT C.O.T. STANDARD METHODS AND DRAWINGS: 1000 TO 10400.
 - EACH ALLLOTMENT IS SERVED BY A 100MM PROPERTY CONNECTION.
 - O.B'S ARE LOCATED 1.5m FROM DOWNSTREAM ALIGNMENT.
 - PROPERTY CONNECTION BRANCHES EXTEND INTO THE PROPERTY A MINIMUM OF 1.0M.
 - INSTALLATION AND COMPACTION OF TRENCH BACKFILL WAS CARRIED OUT STRICTLY IN ACCORDANCE WITH C.O.T. AUS. SPEC. AND TO THE COMPACTION VALUES SHOWN IN THE JOB SPECIFICATION SCHEDULES.
 - ALL WORK ASSOCIATED WITH LIVE SEWERS OR MANHOLES WAS CARRIED OUT BY THE CONTRACTOR UNDER THURINGOWA CITY COUNCIL SUPERVISION.
 - THE CONTRACTOR VERIFIED LOCATIONS OF EXISTING SERVICES WITH ALL RELEVANT AUTHORITIES BEFORE COMMENCING CONSTRUCTION.
 - THE CONSTRUCTION OF SEWERAGE WORK SHOWN ON THIS DRAWING WAS SUPERVISED IN ACCORDANCE WITH C.O.T. POLICIES AND DEPARTMENT OF LOCAL GOVERNMENT REQUIREMENTS.
 - PROPERTY CONNECTIONS CROSSING U/G ELECTRICITY ALLOCATION HAVE A MINIMUM OF 1.0m COVER.
 - TOP OF MANHOLES ARE 150mm ABOVE F.S.L. AS PER C.O.T. STANDARD DWGS.
 - ROAD CROSSINGS ARE BACKFILLED WITH CRUSHER DUST COMPACTED TO NOT LESS THAN 95% OF THE STANDARD MAX. DRY DENSITY TO A.S. 1289, INC. FUTURE ROAD CROSSINGS.
 - SEWER MANHOLES ARE LOCATED 1.5M FROM THE PROPERTY BOUNDARIES U.N.O.

DATUM
 PM No. 137651 LOCATED ON
 HERVEY RANGE ROAD (BOLT IN BITUMEN)
 RL 19.248

Full Size A1

No.	Amendments	By	Appd	Date	No.	Amendments	By	Appd	Date
B	AMENDMENTS AS PER COT REQUEST 05.12.06	JAM		06.12.06					
A	ORIGINAL ISSUE	CH	NKB	16.11.06					



Civil Engineers
 Structural Engineers
 Project Managers
 ABN 23 010 743 082

Townsville Office: 67 Mitchell Street, Townsville, P.O. Box 6729, Townsville, QLD 4810
 Ph: (07) 4760 7033, Fax: (07) 4760 7027, Email: info@bmdconsulting.com.au, www.bmd.com.au
 Head Office - Brisbane: 400 St. George Street, Brisbane, QLD 4000
 Ph: (07) 3883 1611, Fax: (07) 4006 1644
 Cairns Office: 100 St. George Street, Cairns, QLD 4870
 Ph: (07) 5558 5600

Design	CH
Drawn	CH
Checked	JAM
Original Approved By:	MKB
REPEC No.	5555
Date	NOV 06
Drawn	A.H.D.

Client	URBEX Pty Ltd	Project	KALYNDIA CHASE - STAGE 3	Title	"AS CONSTRUCTED" SEWERAGE RETICULATION LAYOUT PLAN Sheet 1 of 5	Drawing No.	CT-1172-228	Rev	B
Client	URBEX Pty Ltd								

THIS DRAWING CANNOT BE COPIED OR REPRODUCED IN ANY FORM OR USED FOR ANY OTHER PURPOSE OTHER THAN THAT ORIGINALLY INTENDED WITHOUT THE WRITTEN PERMISSION OF BMD CONSULTING PTY LTD

FOR CONTINUATION REFER DWG. CT-1172-230

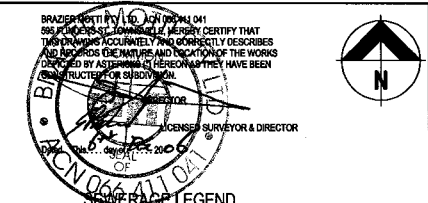

SYMBOLS LEGEND

- EXISTING SEWERAGE
- FUTURE SEWERAGE
- SEWERAGE
- LIMIT OF WORKS - STAGE 3
- SEWER MANHOLE (M.H.)
- TOP OF MANHOLE R.L.
- MANHOLE NUMBER
- LINE NUMBER

HOUSE CONNECTION TYPES		
		TYPE A DIRECT CONNECTION
		TYPE B JUMP UP
		TYPE C DIRECT DOWN
		TYPE D REVERSE DROP

SEWERAGE NOTES

1. ALL LINES LESS THAN 5.7m DEEP ARE 150MM DIAMETER PVCU DWV S/NB IN ACCORDANCE WITH STANDARD AS/NZS 1260:1999, UNLESS SHOWN OTHERWISE.
2. ALL 100mm DIAMETER SEWER LINES LESS THAN 5.7m DEEP ARE PVCU DWV S/NB IN ACCORDANCE WITH STANDARD AS/NZS 1260:1999, UNLESS SHOWN OTHERWISE.
3. CONTRACTOR VERIFIED FINISHED SURFACE LEVELS ON SITE BEFORE CONSTRUCTION OF SEWERS AND PROPERTY CONNECTION BRANCHES.
4. ALL WORK WERE CONSTRUCTED IN ACCORDANCE WITH CURRENT C.O.T. STANDARD METHODS AND DRAWINGS: 10400 TO 10490.
5. EACH ALLOTMENT IS SERVED BY A 100MM PROPERTY CONNECTION.
6. O.B'S ARE LOCATED 1.5m FROM DOWNSTREAM ALIGNMENT.
7. PROPERTY CONNECTION BRANCHES EXTEND INTO THE PROPERTY A MINIMUM OF 1.0M.
8. INSTALLATION AND COMPACTION OF TRENCH BACKFILL WAS CARRIED OUT STRICTLY IN ACCORDANCE WITH C.O.T. AUS. SPEC. AND TO THE COMPACTION VALUES SHOWN IN THE JOB SPECIFICATION SCHEDULES.
9. ALL WORK ASSOCIATED WITH LIVE SEWERS OR MANHOLES WAS CARRIED OUT BY THE CONTRACTOR UNDER THIRURINGOWA CITY COUNCIL SUPERVISION.
10. THE CONTRACTOR VERIFIED LOCATIONS OF EXISTING SERVICES WITH ALL RELEVANT AUTHORITIES BEFORE COMMENCING CONSTRUCTION.
11. THE CONSTRUCTION OF SEWERAGE WORK SHOWN ON THIS DRAWING WAS SUPERVISED IN ACCORDANCE WITH C.O.T. POLICIES AND DEPARTMENT OF LOCAL GOVERNMENT REQUIREMENTS.
12. PROPERTY CONNECTIONS CROSSING U/G ELECTRICITY ALLOCATION HAVE A MINIMUM OF 1.0m COVER.
13. TOP OF MANHOLES ARE 150mm ABOVE F.S.L. AS PER C.O.T. STANDARD DWGS.
14. ROAD CROSSINGS ARE BACKFILLED WITH CRUSHER DUST COMPACTED TO NOT LESS THAN 95% OF THE STANDARD MAX. DRY DENSITY TO A.S. 1299, INC. FUTURE ROAD CROSSINGS.
15. SEWER MANHOLES ARE LOCATED 1.5M FROM THE PROPERTY BOUNDARIES U.N.O.

DATUM

PM No: 131651 LOCATED ON HERVEY RANGE ROAD (BOLT IN BITUMEN) RL 19.248

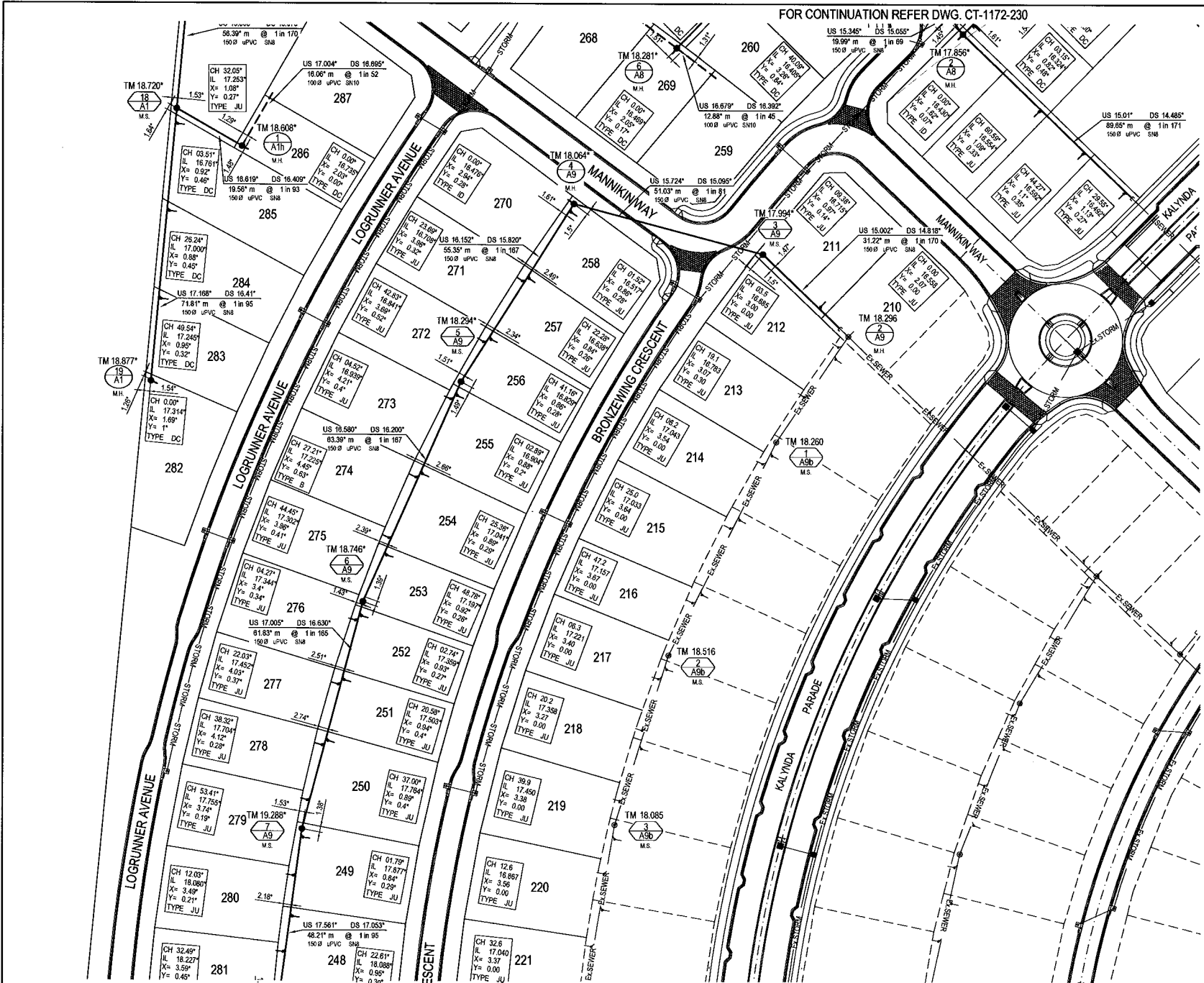
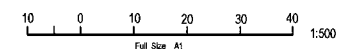

FOR CONTINUATION REFER DWG. CT-1172-228

No.	Amendments	By	Appd	Date	No.	Amendments	By	Appd	Date
B	AMENDMENTS AS PER COT REQUEST 05.12.06	JAM		05.12.06					
A	ORIGINAL ISSUE	CH	MMR	16.11.06					

THIS DRAWING CANNOT BE COPIED OR REPRODUCED IN ANY FORM OR USED FOR ANY OTHER PURPOSE OTHER THAN THAT ORIGINALLY INTENDED WITHOUT THE WRITTEN PERMISSION OF BMD CONSULTING PTY LTD.

Civil Engineers
Structural Engineers
Project Managers

BMD CONSULTING

Townsville Office: 07 4180 7000
 Mackay Office: 07 4780 7077
 Brisbane Office: 07 3285 1511
 Gold Coast Office: 07 5598 5400

Client: **URBEX Pty Ltd**

Project: **KALYNDIA CHASE - STAGE 3**

Title: **"AS CONSTRUCTED" SEWERAGE RETICULATION LAYOUT PLAN Sheet 2 of 5**

Original Approved By: MKB

R/REQ No: 5555

Date: NOV '06

Datum: A.H.D.

AS CONSTRUCTED

Drawing No: **CT-1172-229**

Rev: **B**

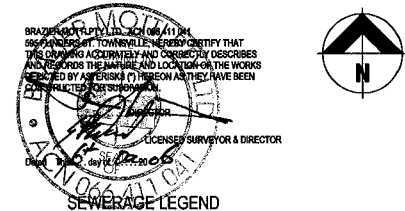

SEWERAGE LEGEND

EXISTING SEWERAGE	
FUTURE SEWERAGE	
SEWERAGE	
LIMIT OF WORKS - STAGE 3	
SEWER MANHOLE (M.H.)	
TOP OF MANHOLE R.L.	
MANHOLE NUMBER	
LINE NUMBER	

HOUSE CONNECTION TYPES

	TYPE A DIRECT CONN.
	TYPE B JUMP-UP
	TYPE C DIRECT CONN. M.H.
	TYPE D EXTERNAL DROP

SEWERAGE NOTES

- ALL LINES LESS THAN 5.7m DEEP ARE 150MM DIAMETER PVCU DWV SNB IN ACCORDANCE WITH STANDARD ASNZS 1260:1999. UNLESS SHOWN OTHERWISE.
- ALL 100mm DIAMETER SEWER LINES LESS THAN 5.7m DEEP ARE PVCU DWV SNB IN ACCORDANCE WITH STANDARD ASNZS 1260:1999. UNLESS SHOWN OTHERWISE.
- CONTRACTOR VERIFIED FINISHED SURFACE LEVELS ON SITE BEFORE CONSTRUCTION OF SEWERS AND PROPERTY CONNECTION BRANCHES.
- ALL WORK WERE CONSTRUCTED IN ACCORDANCE WITH CURRENT C.O.T. STANDARD METHODS AND DRAWINGS. 10400 TO 10460.
- EACH ALLIMENT IS SERVED BY A 100MM PROPERTY CONNECTION.
- O.B.'S ARE LOCATED 1.5m FROM DOWNSTREAM ALIGNMENT.
- PROPERTY CONNECTION BRANCHES EXTEND INTO THE PROPERTY A MINIMUM OF 1.0M.
- INSTALLATION AND COMPACTION OF TRENCH BACKFILL WAS CARRIED OUT STRICTLY IN ACCORDANCE WITH C.O.T. AUS. SPEC. AND TO THE COMPACTION VALUES SHOWN IN THE JOB SPECIFICATION SCHEDULES.
- ALL WORK ASSOCIATED WITH LIVE SEWERS OR MANHOLES WAS CARRIED OUT BY THE CONTRACTOR UNDER THURINGOWA CITY COUNCIL SUPERVISION.
- THE CONTRACTOR VERIFIED LOCATIONS OF EXISTING SERVICES WITH ALL RELEVANT AUTHORITIES BEFORE COMMENCING CONSTRUCTION.
- THE CONSTRUCTION OF SEWERAGE WORK SHOWN ON THIS DRAWING WAS SUPERVISED IN ACCORDANCE WITH C.O.T. POLICIES AND DEPARTMENT OF LOCAL GOVERNMENT REQUIREMENTS.
- PROPERTY CONNECTIONS CROSSING U/G ELECTRICITY ALLOCATION HAVE A MINIMUM OF 1.0m COVER.
- TOP OF MANHOLES ARE 150mm ABOVE F.S.L. AS PER C.O.T. STANDARD DWGS.
- Road CROSSINGS ARE BACKFILLED WITH CRUSHER DUST COMPACTED TO NOT LESS THAN 95% OF THE STANDARD MAX. DRY DENSITY TO A.S. 1288, INC. FUTURE ROAD CROSSINGS.
- SEWER MANHOLES ARE LOCATED 1.5M FROM THE PROPERTY BOUNDARIES U.M.O.

DATUM

PM No. 131651 LOCATED ON HERVEY RANGE ROAD (BOLT IN BITUMEN)
RL 19.248

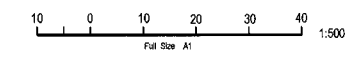

B	AMENDMENTS AS PER COT REQUEST 05.12.06	JAM	05.12.06	
A	ORIGINAL ISSUE	CH	16.11.06	

No. Amendments By Appd Date No. Amendments By Appd Date

THIS DRAWING CANNOT BE COPIED OR REPRODUCED IN ANY FORM OR USED FOR ANY OTHER PURPOSE OTHER THAN THAT ORIGINALLY INTENDED WITHOUT THE WRITTEN PERMISSION OF BMD CONSULTING PTY LTD



Civil Engineers
Structural Engineers
Project Managers
ANZ 20 010 743 692

BMD CONSULTING

Townsville Office
67 Market Street
Townsville
QLD 4810
Australia

Ph (07) 4750 7000
Fax (07) 4750 7077
Email: townsville@bmd.com.au
www.bmd.com.au

Head Office - Brisbane
Ph (07) 3885 1511
Brisbane Office
Ph (07) 3885 5500

Design	CH
Drawn	CH
Checked	JAM
Original Approved By:	MKB
Date	NOV '06
Drawn	A.H.D.

Client
URBEX Pty Ltd

Project
KALYNDIA CHASE - STAGE 3

Title
"AS CONSTRUCTED" SEWERAGE RETICULATION

Drawing No.
CT-1172-230

Rev
B

Layout Plan Sheet 3 of 5



BRAZIER MOTTI PTY LTD. ACN 068 411 041
 395 FLINDERS ST. PLOUNVILLE, HEREBY CERTIFY THAT
 THIS DRAWING ACCURATELY AND CORRECTLY DESCRIBES
 AND RECORDS THE NATURE AND LOCATION OF THE WORKS
 DEPICTED BY THE PERISKS (M) HEREON AS THEY HAVE BEEN
 CONSTRUCTED BY THE CONTRACTOR.



- SEWERAGE LEGEND**
- EXISTING SEWERAGE
 - FUTURE SEWERAGE
 - SEWERAGE
 - LIMIT OF WORKS - STAGE 3
 - SEWER MANHOLE (M.H.)
 - TOP OF MANHOLE R.L.
 - MANHOLE NUMBER
 - LINE NUMBER

HOUSE CONNECTION TYPES

	TYPE A DIRECT COON
	TYPE B JUMP UP
	TYPE C DIRECT COON S/S
	TYPE D VERTICAL DROP

FOR CONTINUATION REFER DWG. CT-1172-232



SEWERAGE NOTES

1. ALL LINES LESS THAN 5.7m DEEP ARE 150MM DIAMETER PVCU DWV S/N8 IN ACCORDANCE WITH STANDARD AS/NZS 1280:1999. UNLESS SHOWN OTHERWISE.
2. ALL 100mm DIAMETER SEWER LINES LESS THAN 5.7m DEEP ARE PVCU DWV S/N10 IN ACCORDANCE WITH STANDARD AS/NZS 1280:1999. UNLESS SHOWN OTHERWISE.
3. CONTRACTOR VERIFIED FINISHED SURFACE LEVELS ON SITE BEFORE CONSTRUCTION OF SEWERS AND PROPERTY CONNECTION BRANCHES.
4. ALL WORK WERE CONSTRUCTED IN ACCORDANCE WITH CURRENT C.O.T. STANDARD METHODS AND DRAWINGS: 10400 TO 10400.
5. EACH ALLOTMENT IS SERVED BY A 100MM PROPERTY CONNECTION.
6. O.B'S ARE LOCATED 1.5m FROM DOWNSTREAM ALIGNMENT.
7. PROPERTY CONNECTION BRANCHES EXTEND INTO THE PROPERTY A MINIMUM OF 1.0M.
8. INSTALLATION AND COMPACTION OF TRENCH BACKFILL WAS CARRIED OUT STRICTLY IN ACCORDANCE WITH C.O.T. AUS. SPEC. AND TO THE COMPACTION VALUES SHOWN IN THE JOB SPECIFICATION SCHEDULES.
9. ALL WORK ASSOCIATED WITH LIVE SEWERS OR MANHOLES WAS CARRIED OUT BY THE CONTRACTOR UNDER THURINGOWA CITY COUNCIL SUPERVISION.
10. THE CONTRACTOR VERIFIED LOCATIONS OF EXISTING SERVICES WITH ALL RELEVANT AUTHORITIES BEFORE COMMENCING CONSTRUCTION.
11. THE CONSTRUCTION OF SEWERAGE WORK SHOWN ON THIS DRAWING WAS SUPERVISED IN ACCORDANCE WITH C.O.T. POLICIES AND DEPARTMENT OF LOCAL GOVERNMENT REQUIREMENTS.
12. PROPERTY CONNECTIONS CROSSING U/G ELECTRICITY ALIGNMENT HAVE A MINIMUM OF 1.0m COVER.
13. TOP OF MANHOLES ARE 150mm ABOVE F.S.L. AS PER C.O.T. STANDARD DWGS.
14. ROAD CROSSINGS ARE BACKFILLED WITH CRUSHER DUST COMPACTED TO NOT LESS THAN 95% OF THE STANDARD MAX. DRY DENSITY TO A.S. 1289. INC. FUTURE ROAD CROSSINGS.
15. SEWER MANHOLES ARE LOCATED 1.5M FROM THE PROPERTY BOUNDARIES U.N.O.

DATUM

FM No.131651 LOCATED ON
 HERVEY RANGE ROAD (BOLT IN BITUMEN)
 RL 19.248

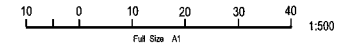

FOR CONTINUATION REFER DWG. CT-1172-230

No.	Amendments	By	Appd	Date	No.	Amendments	By	Appd	Date
A	ORIGINAL ISSUE	CH		16.11.08					



Civil Engineers
 Structural Engineers
 Project Managers



Townsville Office
 37 Mitchell Street,
 Townsville
 P.O. Box 6006
 Townsville, QLD 4810
 Ph: (07) 4150 1860
 Fax: (07) 4150 7077
 Email: info@bmd.com.au
 www.bmd.com.au
 Head Office - Brisbane
 100 Creek Road
 Ph: (07) 3893 1511
 Sydney Office
 Ph: (02) 8588 5400

Design	CH
Drawn	CH
Checked	JAM
Original Approved By:	MKS
RPEO No.	5555
Date	NOV '08
Datum	A.H.D.

Client	URBEX Pty Ltd
Project	KALYNDA CHASE - STAGE 3
Title	"AS CONSTRUCTED" SEWERAGE RETICULATION LAYOUT PLAN Sheet 4 of 5
Drawing No.	CT-1172-231
Rev	A

THIS DRAWING CANNOT BE COPIED OR REPRODUCED IN ANY FORM OR USED FOR ANY OTHER PURPOSE OTHER THAN THAT ORIGINALLY INTENDED WITHOUT THE WRITTEN PERMISSION OF BMD CONSULTING PTY LTD.

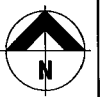

BRAZIER MOTTL PTY LTD
 295 FLINDERS STREET, SYDNEY NSW 1588
 I HEREBY CERTIFY THAT THIS DRAWING ACCURATELY AND CORRECTLY DESCRIBES AND RECORDS THE SCOPE AND LOCATION OF THE WORKS DEPICTED AND THAT THE DESIGN AND CONSTRUCTION HAVE BEEN CONSIDERED IN ACCORDANCE WITH THE RELEVANT STANDARDS.

DATE: 10/11/2016
 DAY OF THE WEEK: MONDAY
 YEAR: 2016

SEAL OF THE LICENSED SURVEYOR'S DIRECTOR

SEWERAGE LEGEND

EXISTING SEWERAGE ————

FUTURE SEWERAGE ————

SEWERAGE ————

LIMIT OF WORKS - STAGE 3 - - - - -

SEWER MANHOLE (M.H.)
 TOP OF MANHOLE R.L.
 MANHOLE NUMBER
 LINE NUMBER

TM 17.00'
 1
 A9
 M.H.

HOUSE CONNECTION TYPES	
	TYPE A DIRECT CONN.
	TYPE B JUMP UP
	TYPE C DIRECT CONN. W/ H.
	TYPE D INTERNAL DROP

SEWERAGE NOTES

- ALL LINES LESS THAN 5.7m DEEP ARE 150MM DIAMETER PVCU DWV SN8 IN ACCORDANCE WITH STANDARD AS/NZS 1260:1999. UNLESS SHOWN OTHERWISE.
- ALL 100mm DIAMETER SEWER LINES LESS THAN 5.7m DEEP ARE PVCU DWV SN10 IN ACCORDANCE WITH STANDARD AS/NZS 1260:1999. UNLESS SHOWN OTHERWISE.
- CONTRACTOR VERIFIED FINISHED SURFACE LEVELS ON SITE BEFORE CONSTRUCTION OF SEWERS AND PROPERTY CONNECTION BRANCHES.
- ALL WORK WERE CONSTRUCTED IN ACCORDANCE WITH CURRENT C.O.T. STANDARD METHODS AND DRAWINGS 1040 TO 1046.
- EACH ALLOTMENT IS SERVED BY A 100MM PROPERTY CONNECTION.
- O.B'S ARE LOCATED 1.5m FROM DOWNSTREAM ALIGNMENT.
- PROPERTY CONNECTION BRANCHES EXTEND INTO THE PROPERTY A MINIMUM OF 1.0M STRICTLY IN ACCORDANCE WITH C.O.T. AUS. SPEC. AND TO THE COMPACTION VALUES SHOWN IN THE JOB SPECIFICATION SCHEDULES.
- ALL WORK ASSOCIATED WITH LIVE SEWERS OR MANHOLES WAS CARRIED OUT BY THE CONTRACTOR UNDER THURINGOWA CITY COUNCIL SUPERVISION.
- THE CONTRACTOR VERIFIED LOCATIONS OF EXISTING SERVICES WITH ALL RELEVANT AUTHORITIES BEFORE COMMENCING CONSTRUCTION.
- THE CONSTRUCTION OF SEWERAGE WORK SHOWN ON THIS DRAWING WAS SUPERVISED IN ACCORDANCE WITH C.O.T. POLICIES AND DEPARTMENT OF LOCAL GOVERNMENT REQUIREMENTS.
- PROPERTY CONNECTIONS CROSSING U/G ELECTRICITY ALLOCATION HAVE A MINIMUM OF 1.0m COVER.
- TOP OF MANHOLES ARE 150mm ABOVE F.S.L., AS PER C.O.T. STANDARD DWGS.
- ROAD CROSSINGS ARE BACKFILLED WITH CRUSHER DUST COMPACTED TO NOT LESS THAN 95% OF THE STANDARD MAX. DRY DENSITY TO A 5.125m INC. FUTURE ROAD CROSSINGS.
- SEWER MANHOLES ARE LOCATED 1.5m FROM THE PROPERTY BOUNDARIES U.N.O.

DATUM

PM No 131651 LOCATED ON HERVEY RANGE ROAD (BOLT IN BITUMEN); RL 19.248

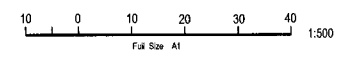

FOR CONTINUATION REFER DWG. CT-1172-231

No.	Amendments	By	Appd	Date	No.	Amendments	By	Appd	Date
A	ORIGINAL ISSUE	CH	f	16.11.06					

THIS DRAWING CANNOT BE COPIED OR REPRODUCED IN ANY FORM OR USED FOR ANY OTHER PURPOSE OTHER THAN THAT ORIGINALLY INTENDED WITHOUT THE WRITTEN PERMISSION OF BMD CONSULTING PTY LTD



Civil Engineers
 Structural Engineers
 Project Managers
 AEN 23 010 743 692



Townsville Office
 51 Mitchell Street,
 Townsville
 P.O. Box 6026
 Townsville MC, QLD 4810
 Ph: (07) 4750 1000
 Fax: (07) 4750 1017
 email: info@bmd.com.au
 www.bmd.com.au

Field Office - Brisbane
 Ph: (07) 3559 1511
 email: info@bmd.com.au
 www.bmd.com.au

Claira Office
 Ph: (07) 4058 1544
 Fax: (07) 3558 5400

Design	CH
Drawn	CH
Checked	JAM
Original Approved By:	MKB
RPQO No.	5555
Date	NOV '06
Datum	A.H.D.

Client	URBEX Pty Ltd
Project	KALYNDIA CHASE - STAGE 3
Title	"AS CONSTRUCTED" SEWERAGE RETICULATION LAYOUT PLAN Sheet 5 of 5
Drawing No.	CT-1172-232
Rev	A