

**SEWERAGE LEGEND**

- EXISTING SEWERAGE
- FUTURE SEWERAGE
- SEWERAGE
- SEWER MANHOLE (M.H.)  
TOP OF MANHOLE R.L.  
MANHOLE NUMBER  
LINE NUMBER
- MAINTENANCE SHAFT (M.S.)  
TOP OF MANHOLE R.L.  
MANHOLE NUMBER  
LINE NUMBER
- TERMINAL MAINTENANCE  
SHAFT (T.M.S.)  
TOP OF MANHOLE R.L.  
MANHOLE NUMBER  
LINE NUMBER

HOUSE CONNECTION TYPES		
1	2	TYPE A DIRECT CONN.
3	4	TYPE B JUMP-UP
5	6	TYPE C DIRECT CONN.
7	8	TYPE D INTERNAL DROP

**SEWERAGE NOTES**

1. ALL LINES LESS THAN 5.7m DEEP ARE 150MM DIAMETER PVCU DWV S/M IN ACCORDANCE WITH STANDARD AS/NZS 1260-1939, UNLESS SHOWN OTHERWISE.
2. ALL 150mm DIAMETER SEWER LINES LESS THAN 5.7m DEEP ARE PVCU DWV S/M IN ACCORDANCE WITH STANDARD AS/NZS 1260-1939, UNLESS SHOWN OTHERWISE.
3. ALL WORK WAS CONSTRUCTED IN ACCORDANCE WITH CURRENT C.O.T. STANDARD METHODS AND DRAWINGS 10400 TO 10460.
4. 0.8'S LOCATED 15m FROM DOWNSTREAM ALIGNMENT.
5. PROPERTY CONNECTION BRANCHES EXTEND INTO THE PROPERTY A MINIMUM OF 1.0m.
6. INSTALLATION AND COMPACTION OF TRENCH BACKFILL CARRIED OUT STRICTLY IN ACCORDANCE WITH C.O.T. AUS. SPEC. AND TO THE COMPACTION VALUES SHOWN IN THE JOB SPECIFICATION SCHEDULES.
7. ALL WORK ASSOCIATED WITH LIVE SEWERS OR MANHOLES WERE CARRIED OUT BY THE CONTRACTOR UNDER THURRINGONGA CITY COUNCIL SUPERVISION.
8. THE CONTRACTOR VERIFIED LOCATIONS OF EXISTING SERVICES WITH ALL RELEVANT AUTHORITIES BEFORE COMMENCING CONSTRUCTION.
9. THE CONSTRUCTION OF SEWERAGE WORK SHOWN ON THIS DRAWING WERE SUPERVISED IN ACCORDANCE WITH C.O.T. POLICIES AND DEPARTMENT OF LOCAL GOVERNMENT REQUIREMENTS.
10. PROPERTY CONNECTIONS CROSSING W/G ELECTRICITY ALLOCATION HAVE A MINIMUM OF 1.0m COVER.
11. TOP OF MANHOLES ARE 150mm ABOVE F.S.L. AS PER C.O.T. STANDARD DWGS UNLESS LOCATED BEHIND BACK OF KERB IN WHICH CASE THE TOP OF MANHOLES ARE 50mm ABOVE F.S.L. AS PER C.O.T. STANDARD DWGS.
12. SEWER MANHOLES ARE LOCATED 15m FROM THE PROPERTY BOUNDARIES U.N.O.

BRAZIER MOTTI PTY LTD. ACN 066 411 041  
595 FLINDERS ST. TOWNSVILLE, HEREBY CERTIFY THAT  
THIS DRAWING ACCURATELY AND CORRECTLY DESCRIBES  
AND RECORDS THE NATURE AND LOCATION OF THE WORKS  
DEPicted BY ASTERISKS (\*) HEREON AS THEY HAVE BEEN  
CONSTRUCTED FOR SUBMISSION

LICENSED SURVEYOR & DIRECTOR  
Dated This 20th day of March 2008

DATUM  
PH No. 131651 LOCATED ON  
HERVEY RANGE ROAD (BOLT IN BITUMEN)  
RL 19.248m AHD

**URBEX PTY LTD**  
**KALYNDA STAGE 5A**

**SEWERAGE RETICULATION**  
**LAYOUT PLAN (SHEET 1 OF 2)**

**AS CONSTRUCTED**  
Drawing No. **CT-1403-103**  
Rev **A**

No.	Amendments	By	Appd	Date	No.	Amendments	By	Appd	Date
B	AMENDED TOP OF MANHOLE LEVEL 11A3a	SJJ		20/03/08					
A	ORIGINAL ISSUE	SJJ		07/02/08					

**BMD CONSULTING**  
Civil Engineers  
Structural Engineers  
& Project Managers  
ADV 23 010 743 881

Design: E.J.C.  
Drawn: E.J.C.  
Checked: J.L.  
Original Approved By: J.L.  
RPEQ No.: 5948  
Date: FEB 2007

Head Office - Brisbane  
Ph: 071 383 5511  
Sydney Office  
Ph: 071 988 5400  
Ph: 071 435 644

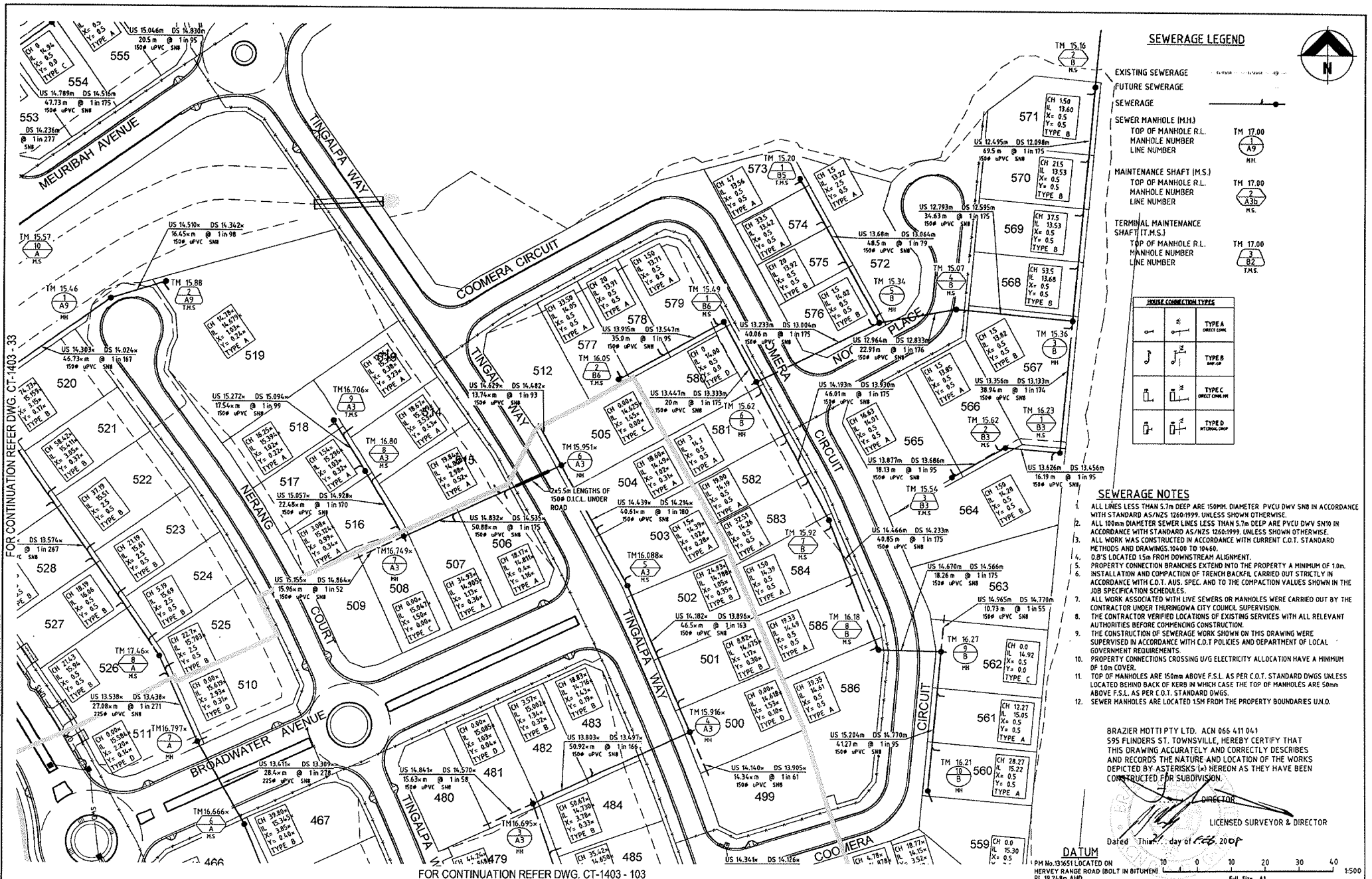

**SEWERAGE LEGEND**

- EXISTING SEWERAGE  
 FUTURE SEWERAGE  
 SEWERAGE  
 SEWER MANHOLE (M.H.)  
 TOP OF MANHOLE R.L.  
 MANHOLE NUMBER  
 LINE NUMBER  
 MAINTENANCE SHAFT (M.S.)  
 TOP OF MANHOLE R.L.  
 MANHOLE NUMBER  
 LINE NUMBER  
 TERMINAL MAINTENANCE  
 SHAFT (T.M.S.)  
 TOP OF MANHOLE R.L.  
 MANHOLE NUMBER  
 LINE NUMBER

**INDICATE CONNECTION TYPES**

	TYPE A DIRECT CONC.
	TYPE B W.P.P.
	TYPE C DIRECT CONC. IN
	TYPE D WETLAND CONC.

**SEWERAGE NOTES**

- ALL LINES LESS THAN 5.7m DEEP ARE 150mm DIAMETER PVCU DWV S/NB IN ACCORDANCE WITH STANDARD AS/NZS 1260:1999, UNLESS SHOWN OTHERWISE.
- ALL 100mm DIAMETER SEWER LINES LESS THAN 5.7m DEEP ARE PVCU DWV S/NB IN ACCORDANCE WITH STANDARD AS/NZS 1260:1999, UNLESS SHOWN OTHERWISE.
- ALL WORK WAS CONSTRUCTED IN ACCORDANCE WITH CURRENT C.O.T. STANDARD METHODS AND DRAWINGS 10400 TO 10460.
- DN'S LOCATED 150 FROM DOWNSTREAM ALIGNMENT.
- PROPERTY CONNECTION BRANCHES EXTEND INTO THE PROPERTY A MINIMUM OF 1.0m.
- INSTALLATION AND COMPACTION OF TRENCH BACKFILL CARRIED OUT STRICTLY IN ACCORDANCE WITH C.O.T. AUS. SPEC. AND TO THE COMPACTION VALUES SHOWN IN THE JOB SPECIFICATION SCHEDULES.
- ALL WORK ASSOCIATED WITH LIVE SEWERS OR MANHOLES WERE CARRIED OUT BY THE CONTRACTOR UNDER THURINGOONA CITY COUNCIL SUPERVISION.
- THE CONTRACTOR VERIFIED LOCATIONS OF EXISTING SERVICES WITH ALL RELEVANT AUTHORITIES BEFORE COMMENCING CONSTRUCTION.
- THE CONSTRUCTION OF SEWERAGE WORK SHOWN ON THIS DRAWING WERE SUPERVISED IN ACCORDANCE WITH C.O.T. POLICIES AND DEPARTMENT OF LOCAL GOVERNMENT REQUIREMENTS.
- PROPERTY CONNECTIONS CROSSING U/G ELECTRICITY ALLOCATION HAVE A MINIMUM OF 1.0m COVER.
- TOP OF MANHOLES ARE 150mm ABOVE F.S.L. AS PER C.O.T. STANDARD DWGS UNLESS LOCATED BEHIND BACK OF KERB IN WHICH CASE THE TOP OF MANHOLES ARE 50mm ABOVE F.S.L. AS PER C.O.T. STANDARD DWGS.
- SEWER MANHOLES ARE LOCATED 15M FROM THE PROPERTY BOUNDARIES U.N.D.

BRAZIER MOTTI PTY LTD. ACN 066 411 041  
 595 FLINDERS ST. TOWNSVILLE, HEREBY CERTIFY THAT  
 THIS DRAWING ACCURATELY AND CORRECTLY DESCRIBES  
 AND RECORDS THE NATURE AND LOCATION OF THE WORKS  
 DEPICTED BY ASTERISKS IN HEREFON AS THEY HAVE BEEN  
 CONDUCTED FOR SUBDIVISION.

LICENSED SURVEYOR & DIRECTOR  
 Dated This 22 day of Feb, 2009

DATUM  
 PH No. 13661 LOCATED ON  
 HERVEY RANGE ROAD (BOLT IN BITUMEN)  
 RL 19.248m AHD  
 Full Size A1

FOR CONTINUATION REFER DWG. CT-1403 - 33

FOR CONTINUATION REFER DWG. CT-1403 - 103

No.	Original Issue	By	Appd	Date	Amendments	By	Appd	Date
A	ORIGINAL ISSUE	SJJ		07/02/08				

THIS DRAWING CANNOT BE COPIED OR REPRODUCED IN ANY FORM OR USED FOR ANY OTHER PURPOSE OTHER THAN THAT ORIGINALLY INTENDED WITHOUT THE WRITTEN PERMISSION OF BMD CONSULTING PTY LTD.



**BMD CONSULTING**  
 Civil Engineers & Project Managers  
 23 210 740 000

Design: E.J.C.  
 Drawn: E.J.C.  
 Checked: J.L.  
 Original Approved By:  
 RPEQ No. 6848  
 Date: FEB 2007  
 Datum: A.H.D.

Client: URBEX PTY LTD  
 Project: KALYNDA STAGE 5A  
 Title: SEWERAGE RETICULATION LAYOUT PLAN (SHEET 2 OF 2)

AS CONSTRUCTED  
 Drawing No. CT-1403-104  
 Rev A