



SEWERAGE LEGEND

- EXISTING SEWERAGE
- FUTURE SEWERAGE
- SEWERAGE
- SEWER MANHOLE (M.H.)
 - TOP OF MANHOLE R.L. TM 17.00
 - MANHOLE NUMBER 1
 - LINE NUMBER A9
 - M.H.
- MAINTENANCE SHAFT (M.S.)
 - TOP OF MANHOLE R.L. TM 17.00
 - MANHOLE NUMBER 2
 - LINE NUMBER A3b
 - M.S.
- TERMINAL MAINTENANCE SHAFT (T.M.S.)
 - TOP OF MANHOLE R.L. TM 17.00
 - MANHOLE NUMBER 3
 - LINE NUMBER B2
 - T.M.S.

HOUSE CONNECTION TYPES		
		TYPE A DIRECT CONN.
		TYPE B JUMP-UP
		TYPE C DIRECT CONN. MH
		TYPE D INTERNAL DROP

SEWERAGE NOTES

1. ALL LINES LESS THAN 5.7m DEEP ARE 150MM DIAMETER PVCU DWV S/NB IN ACCORDANCE WITH STANDARD AS/NZS 1260:1999, UNLESS SHOWN OTHERWISE.
2. ALL 100mm DIAMETER SEWER LINES LESS THAN 5.7m DEEP ARE PVCU DWV S/NB IN ACCORDANCE WITH STANDARD AS/NZS 1260:1999, UNLESS SHOWN OTHERWISE.
3. ALL WORK WAS CONSTRUCTED IN ACCORDANCE WITH CURRENT C.O.T. STANDARD METHODS AND DRAWINGS 10400 TO 10460.
4. O.B.'S LOCATED 1.5m FROM DOWNSTREAM ALIGNMENT.
5. PROPERTY CONNECTION BRANCHES EXTEND INTO THE PROPERTY A MINIMUM OF 1.0m.
6. INSTALLATION AND COMPACTION OF TRENCH BACKFILL CARRIED OUT STRICTLY IN ACCORDANCE WITH C.O.T. AUS. SPEC. AND TO THE COMPACTION VALUES SHOWN IN THE JOB SPECIFICATION SCHEDULES.
7. ALL WORK ASSOCIATED WITH LIVE SEWERS OR MANHOLES WERE CARRIED OUT BY THE CONTRACTOR UNDER THURINGOWA CITY COUNCIL SUPERVISION.
8. THE CONTRACTOR VERIFIED LOCATIONS OF EXISTING SERVICES WITH ALL RELEVANT AUTHORITIES BEFORE COMMENCING CONSTRUCTION.
9. THE CONSTRUCTION OF SEWERAGE WORK SHOWN ON THIS DRAWING WERE SUPERVISED IN ACCORDANCE WITH C.O.T. POLICIES AND DEPARTMENT OF LOCAL GOVERNMENT REQUIREMENTS.
10. PROPERTY CONNECTIONS CROSSING U/G ELECTRICITY ALLOCATION HAVE A MINIMUM OF 1.0m COVER.
11. TOP OF MANHOLES ARE 150mm ABOVE F.S.L. AS PER C.O.T. STANDARD DWGS UNLESS LOCATED BEHIND BACK OF KERB IN WHICH CASE THE TOP OF MANHOLES ARE 50mm ABOVE F.S.L. AS PER C.O.T. STANDARD DWGS.
12. SEWER MANHOLES ARE LOCATED 1.5m FROM THE PROPERTY BOUNDARIES U.N.O.

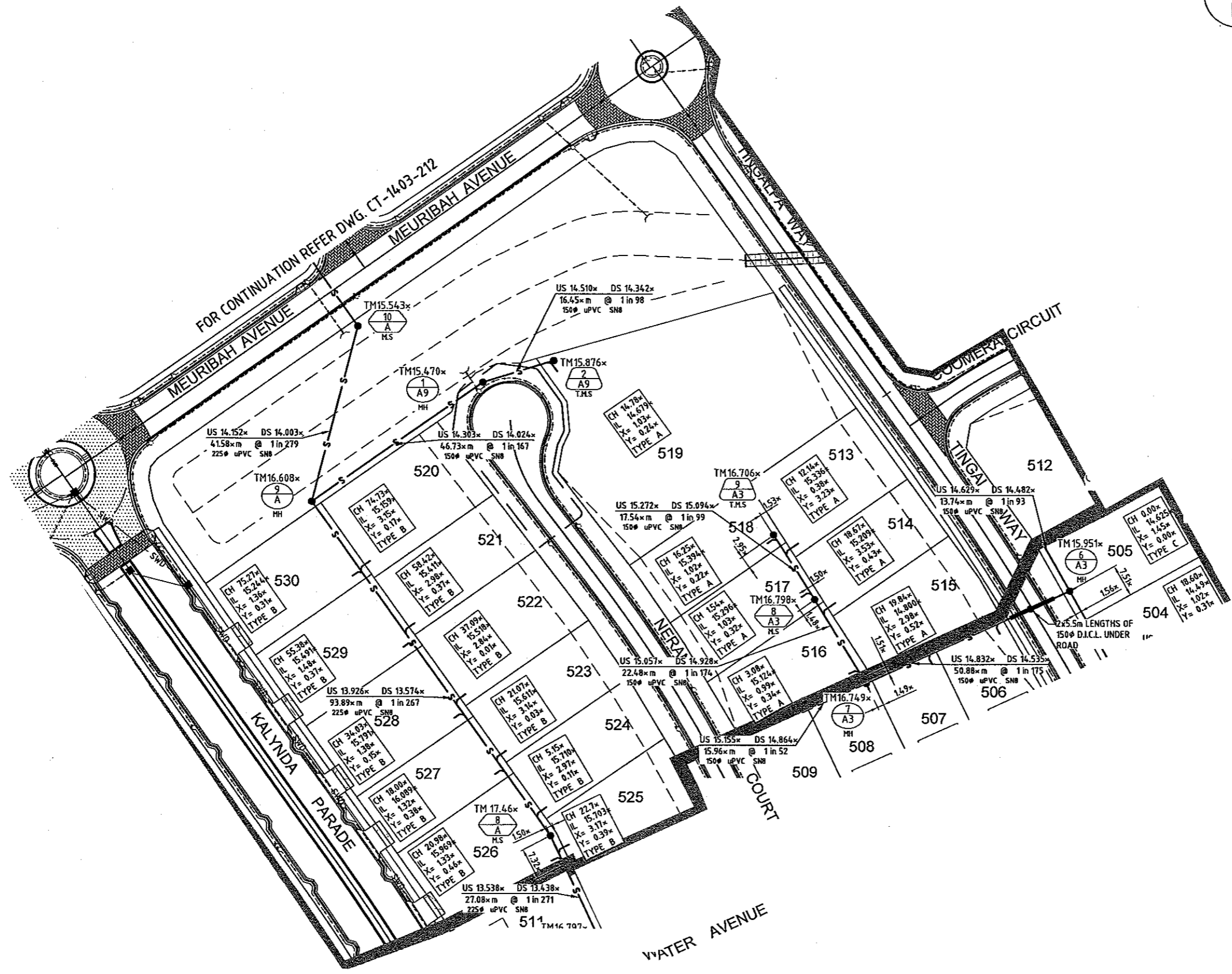

BRAZIER MOTTI PTY LTD. ACN 066 411 041
 595 FLINDERS ST. TOWNSVILLE, HEREBY CERTIFY THAT
 THIS DRAWING ACCURATELY AND CORRECTLY DESCRIBES
 AND RECORDS THE NATURE AND LOCATION OF THE WORKS
 DEPICTED BY AS RISKS THEREON AS THEY HAVE BEEN
 CONSTRUCTED FOR SUBDIVISION

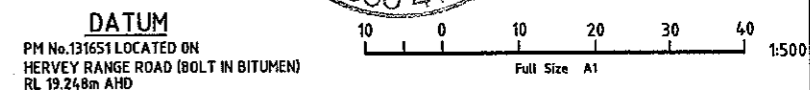
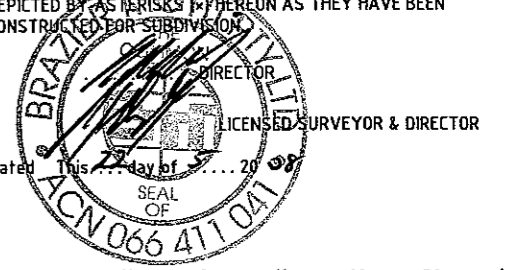

Plot Date: 27/05/2008 14:50 PM
 User: LEONIS MORELLI File Name: J:\CT-1403 - 595 Flinders Ct - Kalymda Stage 5A & Stage 5B\dwg\ct-1403.dwg

No.	Amendments	By	Appd	Date	No.	Amendments	By	Appd	Date
A	ORIGINAL ISSUE		AM	21.05.08					

THIS DRAWING CANNOT BE COPIED OR REPRODUCED IN ANY FORM OR USED FOR ANY OTHER PURPOSE OTHER THAN THAT ORIGINALLY INTENDED WITHOUT THE WRITTEN PERMISSION OF BMD CONSULTING PTY LTD.

BMD Civil Engineers
Structural Engineers
& Project Managers
ACN 23 010 743 892

Townsville Office: 57 Mitchell Street, Townsville, P.O. Box 6908, Townsville, QLD 4810. Ph: (07) 4750 7000, Fax: (07) 4750 7077, email: bmdcorps@bmd.com.au, www.bmd.com.au

Head Office - Brisbane: Ph: (07) 3893 1511
 Sydney Office: Ph: (02) 9898 5400
 Cairns Office: Ph: (07) 4035 1544

Design	AM	Client URBEX PTY LTD Project KALYNDIA STAGE 5B Title SEWERAGE LAYOUT PLAN SHEET 1 OF 2
Drawn	AM	
Checked	JL	
Original Approved By:		
RPEQ No.	548	AS CONSTRUCTED Drawing No. CT-1403-211 Rev A
Date	MAY 2008	

SEWERAGE LEGEND



EXISTING SEWERAGE
 FUTURE SEWERAGE
 SEWERAGE

SEWER MANHOLE (M.H.)
 TOP OF MANHOLE R.L.
 MANHOLE NUMBER
 LINE NUMBER

TM 17.00

 M.H.

MAINTENANCE SHAFT (M.S.)
 TOP OF MANHOLE R.L.
 MANHOLE NUMBER
 LINE NUMBER

TM 17.00

 M.S.

TERMINAL MAINTENANCE SHAFT (T.M.S.)
 TOP OF MANHOLE R.L.
 MANHOLE NUMBER
 LINE NUMBER

TM 17.00

 T.M.S.

HOUSE CONNECTION TYPES

TYPE A	TYPE B	TYPE C	TYPE D
TYPE A DIRECT CONN.	TYPE B STEP-UP	TYPE C DIRECT CONN. M.I.	TYPE D INTERNAL DROP

SEWERAGE NOTES

- ALL LINES LESS THAN 5.7m DEEP ARE 150MM DIAMETER PVCU DWV SN8 IN ACCORDANCE WITH STANDARD AS/NZS 1260:1999, UNLESS SHOWN OTHERWISE.
- ALL 100mm DIAMETER SEWER LINES LESS THAN 5.7m DEEP ARE PVCU DWV SN10 IN ACCORDANCE WITH STANDARD AS/NZS 1260:1999, UNLESS SHOWN OTHERWISE.
- ALL WORK WAS CONSTRUCTED IN ACCORDANCE WITH CURRENT C.O.T. STANDARD METHODS AND DRAWINGS 104.00 TO 104.60.
- O.B'S LOCATED 15m FROM DOWNSTREAM ALIGNMENT.
- PROPERTY CONNECTION BRANCHES EXTEND INTO THE PROPERTY A MINIMUM OF 1.0m.
- INSTALLATION AND COMPACTION OF TRENCH BACKFILL CARRIED OUT STRICTLY IN ACCORDANCE WITH C.O.T. AUS. SPEC. AND TO THE COMPACTION VALUES SHOWN IN THE JOB SPECIFICATION SCHEDULES.
- ALL WORK ASSOCIATED WITH LIVE SEWERS OR MANHOLES WERE CARRIED OUT BY THE CONTRACTOR UNDER THURINGOWA CITY COUNCIL SUPERVISION.
- THE CONTRACTOR VERIFIED LOCATIONS OF EXISTING SERVICES WITH ALL RELEVANT AUTHORITIES BEFORE COMMENCING CONSTRUCTION.
- THE CONSTRUCTION OF SEWERAGE WORK SHOWN ON THIS DRAWING WERE SUPERVISED IN ACCORDANCE WITH C.O.T. POLICIES AND DEPARTMENT OF LOCAL GOVERNMENT REQUIREMENTS.
- PROPERTY CONNECTIONS CROSSING U/G ELECTRICITY ALLOCATION HAVE A MINIMUM OF 1.0m COVER.
- TOP OF MANHOLES ARE 150mm ABOVE F.S.L. AS PER C.O.T. STANDARD DWGS UNLESS LOCATED BEHIND BACK OF KERB IN WHICH CASE THE TOP OF MANHOLES ARE 50mm ABOVE F.S.L. AS PER C.O.T. STANDARD DWGS.
- SEWER MANHOLES ARE LOCATED 15m FROM THE PROPERTY BOUNDARIES U.N.O.

BRAZIER MOTTI PTY LTD. ACN 066 411 041
 595 FLINDERS ST. TOWNSVILLE, HEREBY CERTIFY THAT
 THIS DRAWING IS ACCURATE AND CORRECTLY DESCRIBES
 AND RECORDS THE NATURE AND LOCATION OF THE WORKS
 DEPICTED BY ASTERISKS IN HEREBY AS THEY HAVE BEEN
 CONSTRUCTED FOR SUBDIVISION.

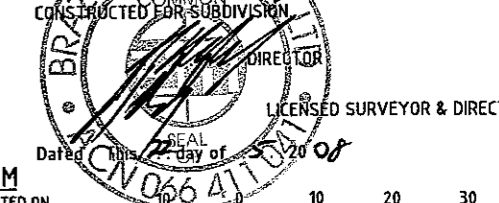

DATUM
 PM No. 131651 LOCATED ON
 HERVEY RANGE ROAD (BOLT IN BITUMEN)
 RL 19.248m AHD

10 20 30 40
 Full Size A1

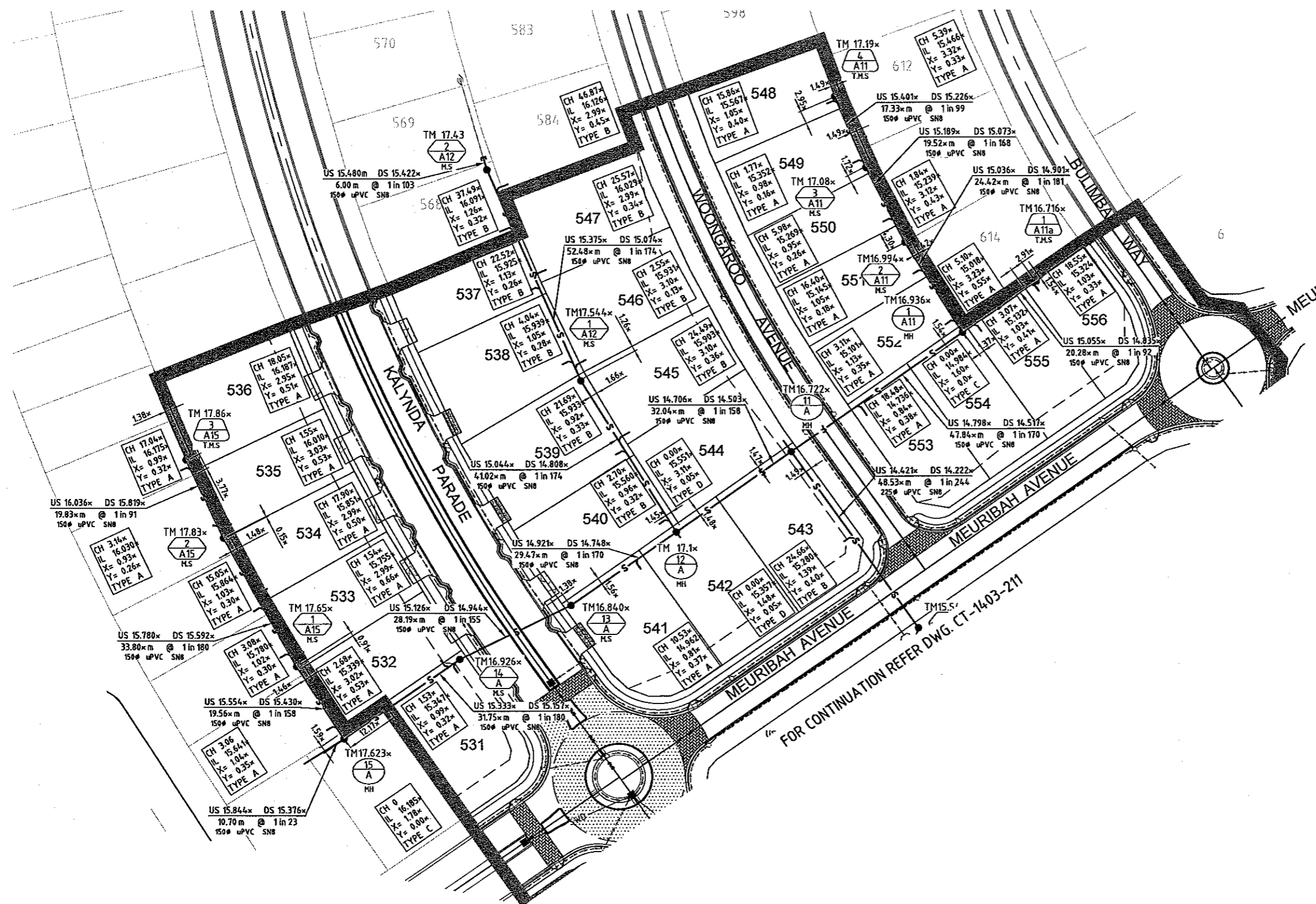

FOR CONTINUATION REFER DWG. CT-1403-211

User: ALEXIS MORELLI File Name: JACT-1403 - 150A (CT-1403) - Kalynda Chase Stage 5A & Stage 5B (Drawing) A1 Con Stamp 28.04.2008 11:59 AM

No.	Amendments	By	Appd	Date	No.	Amendments	By	Appd	Date
A	ORIGINAL ISSUE		AM	21.05.08					

THIS DRAWING CANNOT BE COPIED OR REPRODUCED IN ANY FORM OR USED FOR ANY OTHER PURPOSE OTHER THAN THAT ORIGINALLY INTENDED WITHOUT THE WRITTEN PERMISSION OF BMD CONSULTING PTY LTD.

kalynda chase urbex

BMD CONSULTING
 Civil Engineers
 Structural Engineers
 & Project Managers
 ABN 23 010 745 092

Townsville Office
 57 Mitchell Street,
 Townsville
 P.O. Box 608
 Townsville MC, QLD 4810
 Ph: (07) 4750 7000
 Fax: (07) 4750 7077
 email: bmdcons@bmdcons.com.au
 www.bmd.com.au

Head Office - Brisbane
 Ph: (07) 3893 1511
 Sydney Office
 Ph: (02) 9898 5400
 Cairns Office
 Ph: (07) 4935 1544

Design	AM
Drawn	AM
Checked	JL
Original Approved By:	
RPEQ No.	9348
Date	MAY 2008

Client
URBEX PTY LTD

Project
KALYNDA STAGE 5B

Title
SEWERAGE LAYOUT PLAN
SHEET 2 OF 2

AS CONSTRUCTED
 Drawing No. **CT-1403-212** Rev **A**