

BRAZIER MOTTI PTY LTD. ACN 066 411 041  
 595 FLINDERS ST. TOWNSVILLE, HEREBY CERTIFY THAT  
 THIS DRAWING ACCURATELY AND CORRECTLY DESCRIBES  
 AND RECORDS THE NATURE AND LOCATION OF THE WORKS  
 DEPICTED BY ASTERISKS (\*) HEREON AS THEY HAVE BEEN  
 CONSTRUCTED FOR SUBDIVISION.

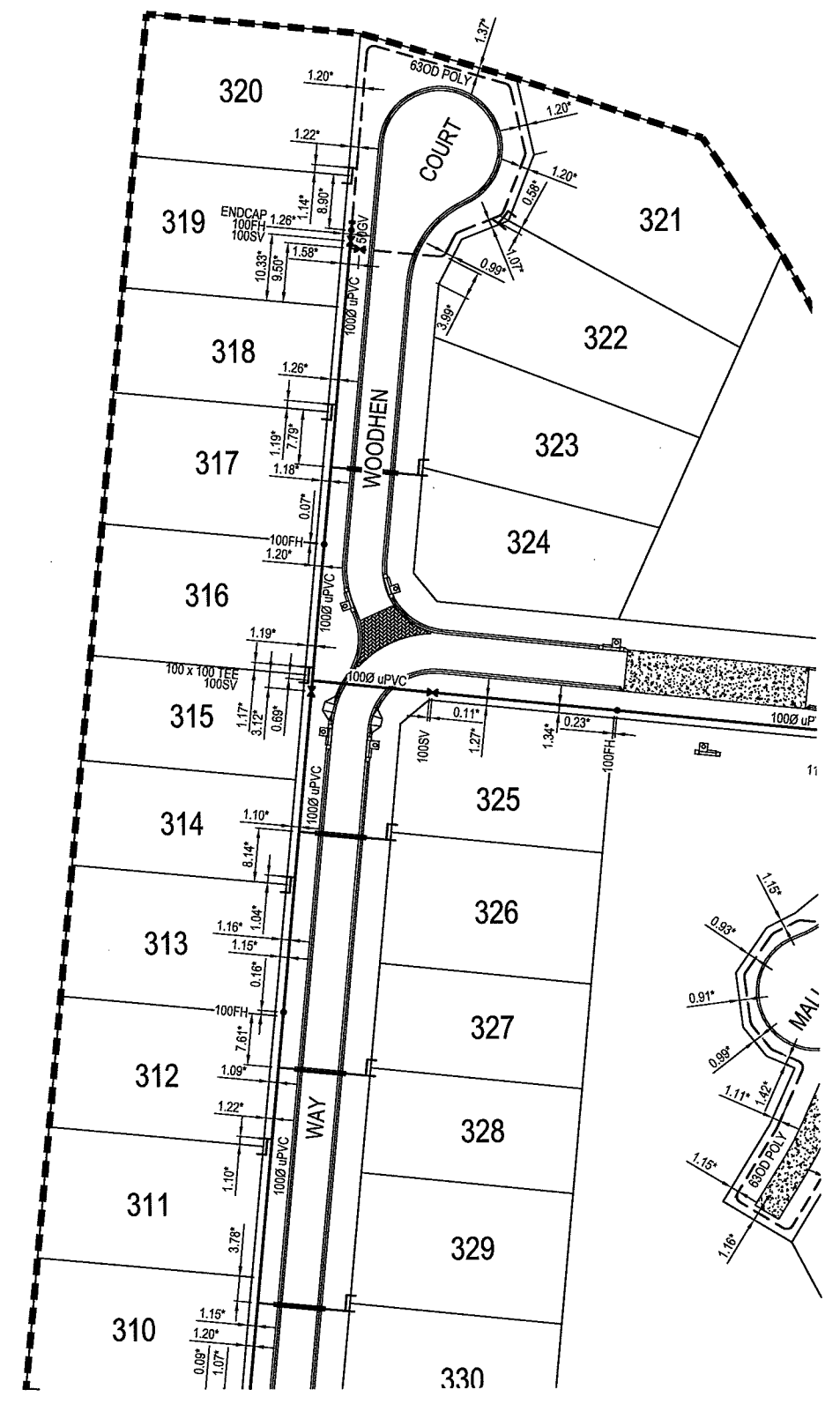
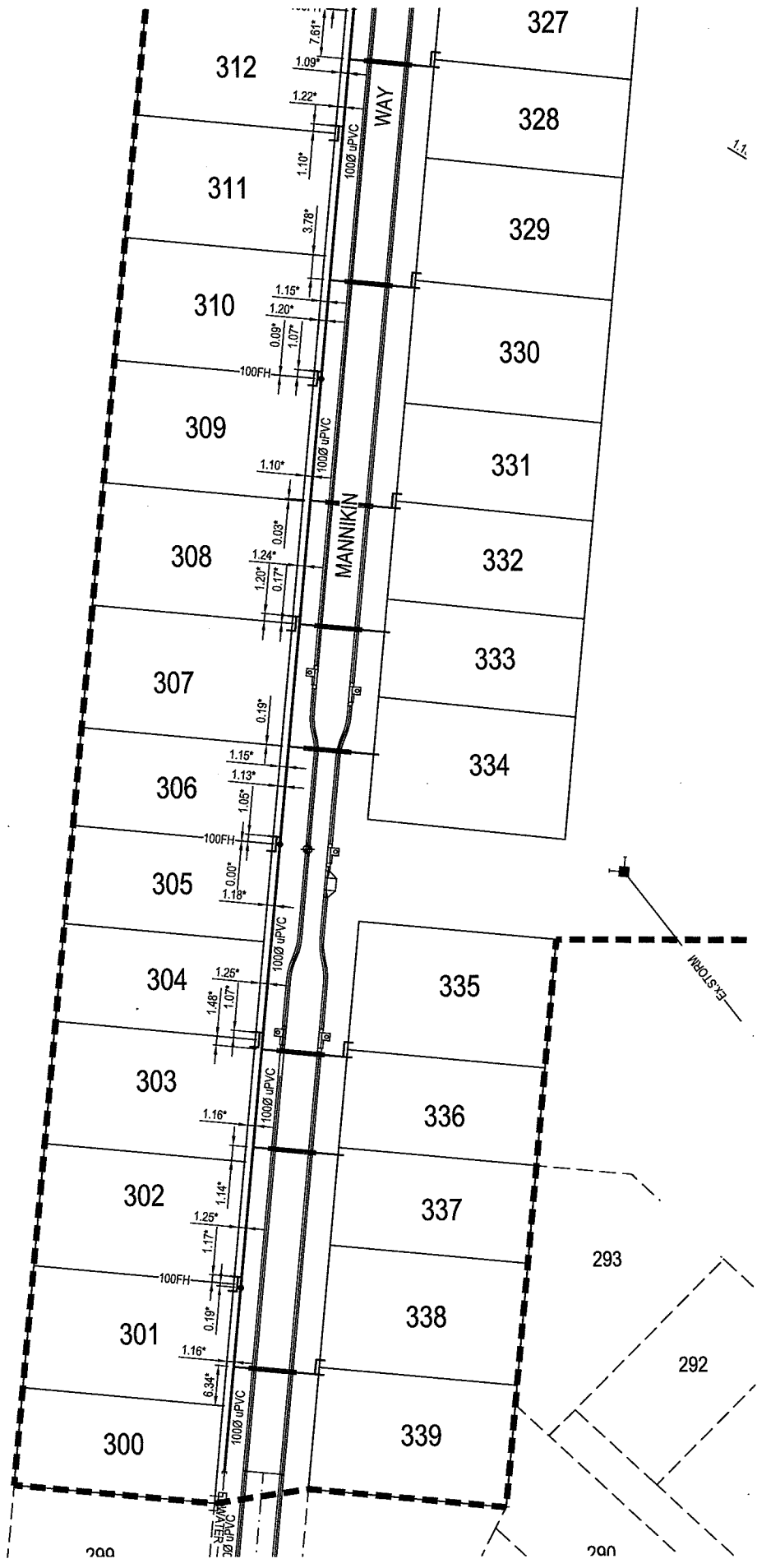
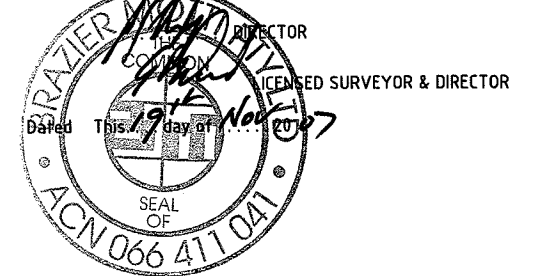

**WATER LEGEND**

- WATER MAIN
- 63 OD POLYETHYLENE LOOP MAIN
- FIRE HYDRANT
- SLUICE VALVE
- GATE VALVE
- TEE
- END CAP
- WATER SERVICE WITH ENVELOPER
- EXIST. WATER MAIN
- EXIST. WATER MAIN (POLY)
- LIMIT OF WORKS - STAGE 4

**WATER NOTES**

1. ALL WATER MAINS ARE LOCATED 1.2m ALIGNMENT OFFSET FROM PROPERTY BOUNDARIES UNLESS SHOWN OTHERWISE
2. THIS DRAWING IS TO BE READ IN CONJUNCTION WITH CITY OF THURINGOWA STANDARD DRAWINGS (WATER).
3. ALL uPVC MAINS ARE SERIES 2, PN16 TO AS/NZS 1477 RUBBER RING JOINTED, WITH SOCKETED D.I.C.L. FITTINGS U.N.O.

**DATUM**

PM No.131651 LOCATED ON  
 HERVEY RANGE ROAD (BOLT IN BITUMEN)  
 RL 19.248m AHD

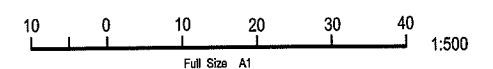

No.	Amendments	By	Appd	Date	No.	Amendments	By	Appd	Date
A	ORIGINAL ISSUE	S.J.J		14/11/07					

**Civil Engineers  
 Structural Engineers  
 Project Managers**  
**ABN 23 010 743 692**

**BMD CONSULTING**

Townsville Office: 57 Mitchell Street, Townsville, P.O. Box 6008, Townsville MC, QLD 4810  
 Ph: (07) 4750 7000, Fax: (07) 4750 7077, email: bmdcon@ng.bmd.com.au, www.bmd.com.au

Head Office - Brisbane: Ph: (07) 3883 1511, Sydney Office: Ph: (02) 9898 5400, Cairns Office: Ph: (07) 4035 1544

Design	S.J.J	Client	URBEX Pty Ltd
Drawn	W.E.S	Project	KALYNDIA CHASE - STAGE 4
Checked		Title	AS CONSTRUCTED
Original Approved By:	<i>[Signature]</i>		
RPEQ No.	5448		
Date	NOV '07		
Datum	A.H.D.		
			WATER RETICULATION LAYOUT PLAN
			SHEET 1 OF 3
			Rev
			CT-1173-516 A

THIS DRAWING CANNOT BE COPIED OR REPRODUCED IN ANY FORM OR USED FOR ANY OTHER PURPOSE OTHER THAN THAT ORIGINALLY INTENDED WITHOUT THE WRITTEN PERMISSION OF BMD CONSULTING PTY LTD.